

MONOCROM.	COR	PENA (PLOTER)	ESPESS. (mm)
1	1	7	0,10
2	2	7	0,20
3	3	7	0,30

MONOCROM.	COR	PENA (PLOTER)	ESPESS. (mm)
4	4	7	0,10
5	5	7	0,20
6	6	7	0,30

MONOCROM.	COR	PENA (PLOTER)	ESPESS. (mm)
7	7	7	0,10
8	8	7	0,10
9	9	7	0,10

MONOCROM.	COR	PENA (PLOTER)	ESPESS. (mm)
10	10	7	0,10
11	11	7	0,20
12	12	7	0,30

MONOCROM.	COR	PENA (PLOTER)	ESPESS. (mm)
13	13	7	0,20
14	14	7	0,20
15	15	7	0,20

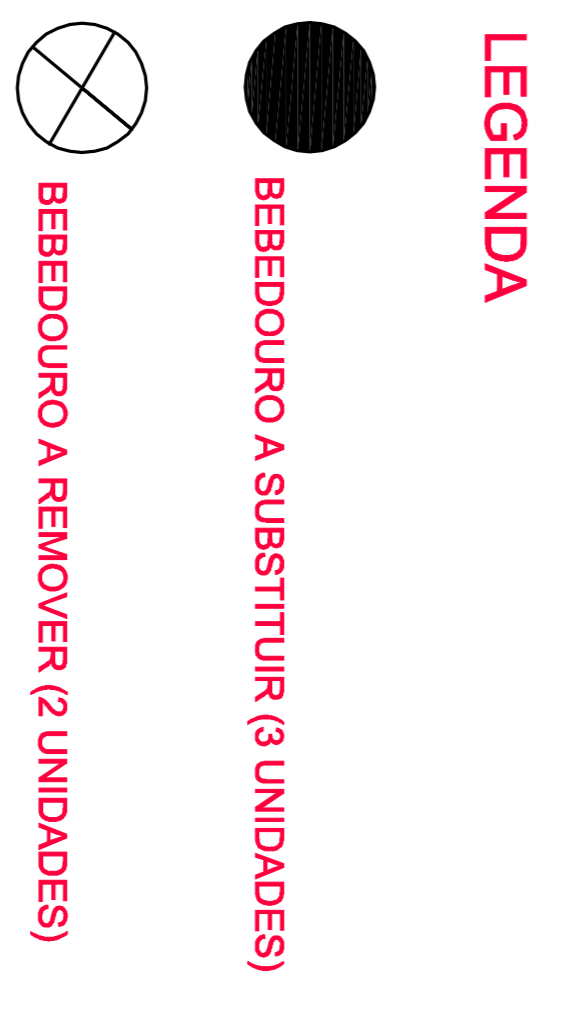
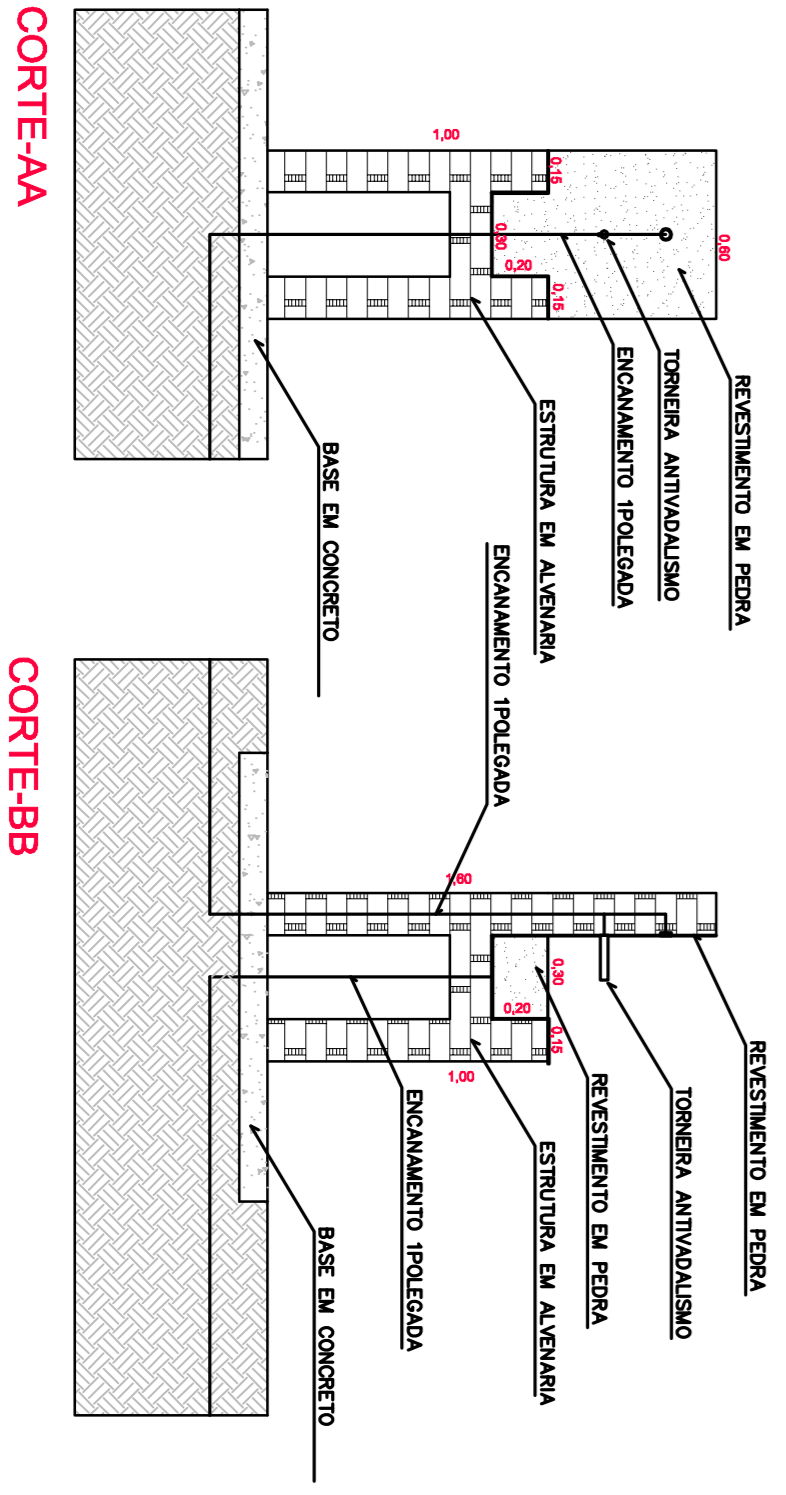
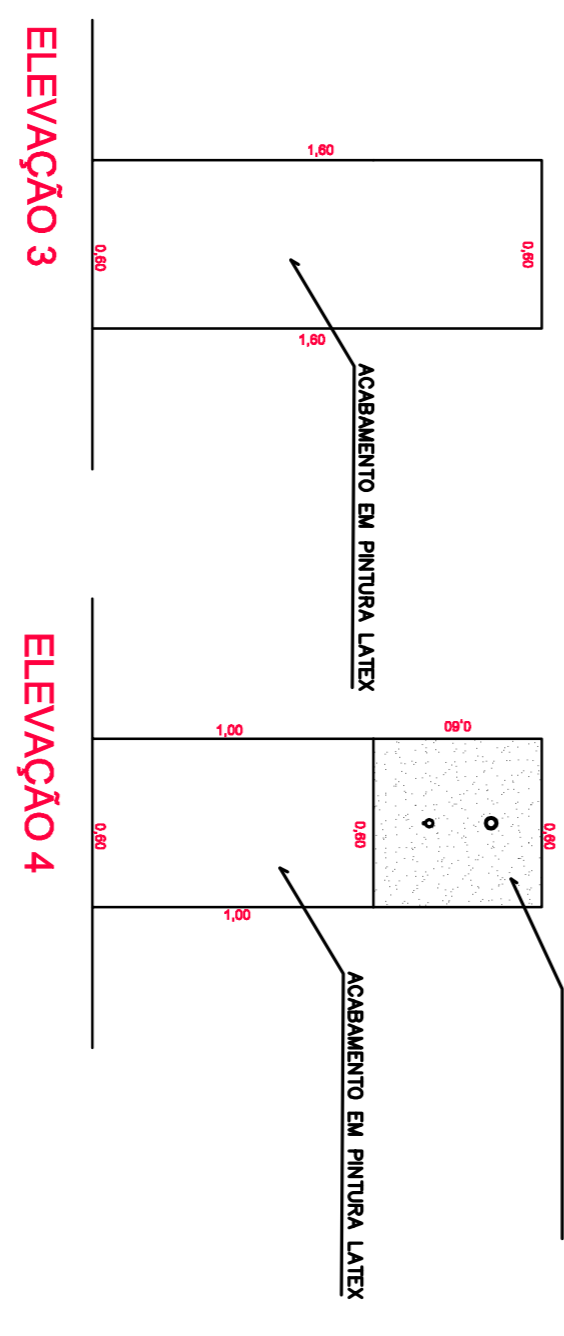
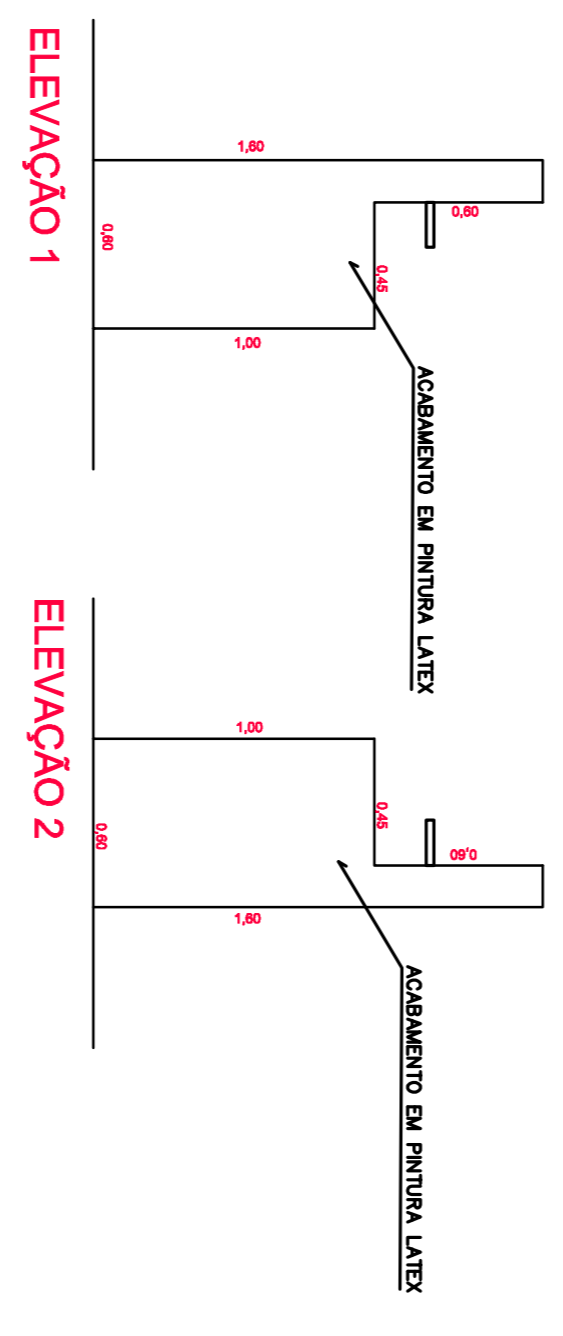
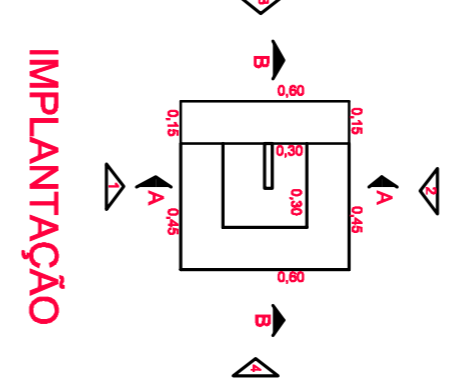
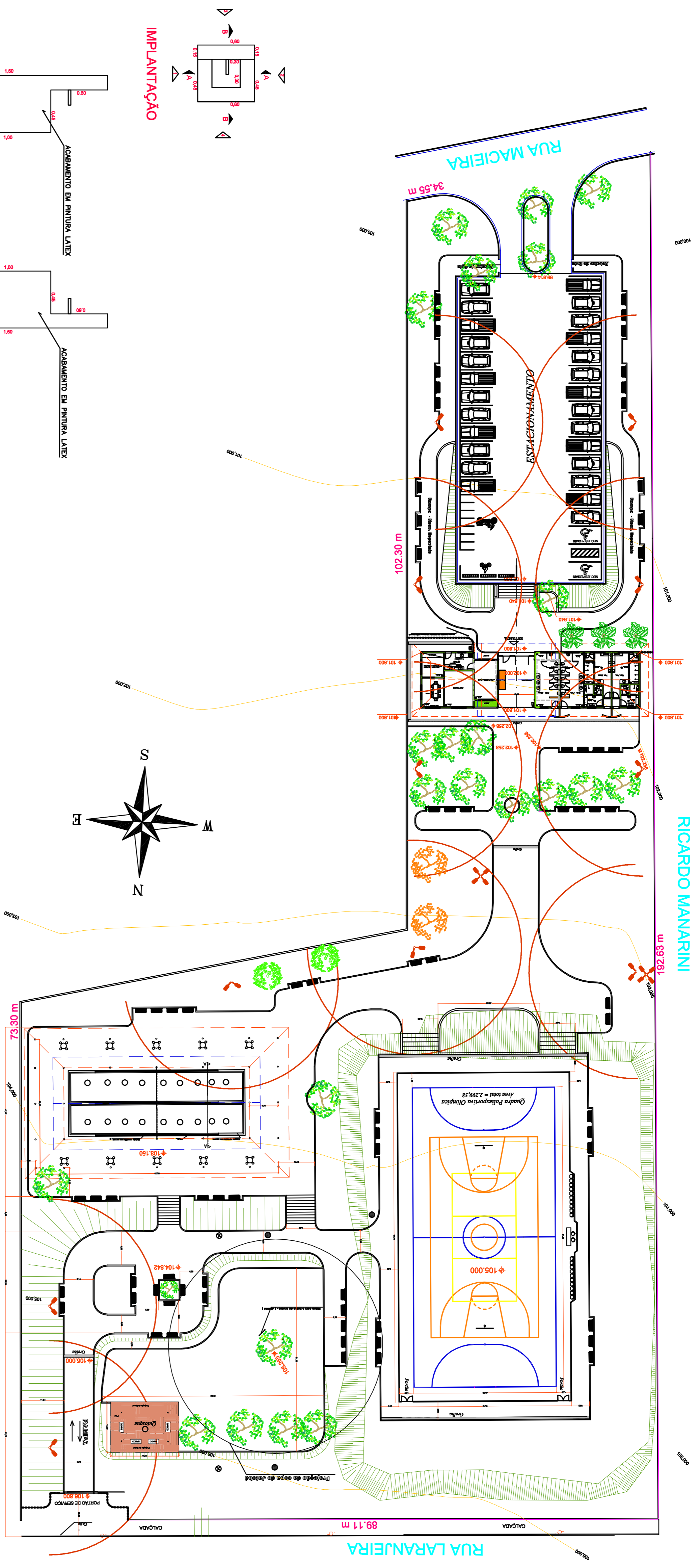

Obs:

SECRETARIA	DEPARTAMENTO
Obras e Serviços	Técnico e de Assessoria
ESCALA	DATA
S/E	18/09/2.018
ISTO	Juca
DESENHO	César Augusto
REVISÃO	00
FOLHA/TOTAL	5/5

P/ Prefeitura do Município de Jaguariúna
 Márcio Gustavo Bernades Reis
 Prefeito

Narciso Alexandre Vendrame
 Engenheiro
 Nº 5080235026

Prefeitura do Município de Jaguariúna
 Rua Alfredo Bueno, 1235 - Centro - Jaguariúna-SP - CEP 13820-000 - Fone: (019) 3867 9700-Fax (019) 3867 2856

ASSUNTO: Revitalização de Praça
 LOCAL: Praça Maria Stella Bianco Torres - Roseira de Cima

Coordenadas: 22°41'45,8"S - 47°01'10,8"W

Folha 5/5

FORMATO A2 - INTERNO: 594 x 420 mm.
 EXTERNO: 594 x 420 mm.