

FACHADA PRINCIPAL - Esc. 1:25

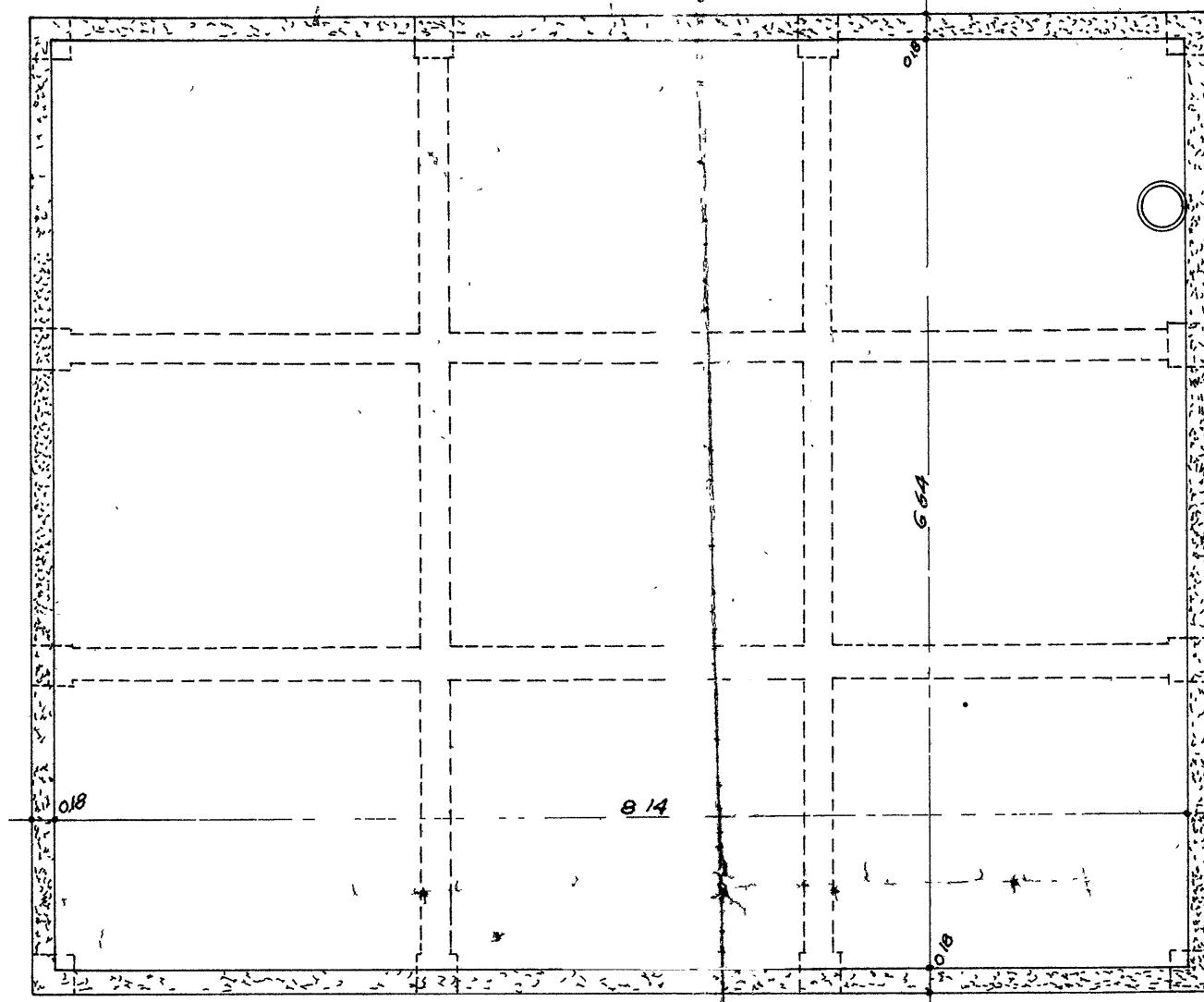

PLANTA - CAIXA DE AGUA ELEVADA. - CAP. 50 m³.
Esc. 1:50

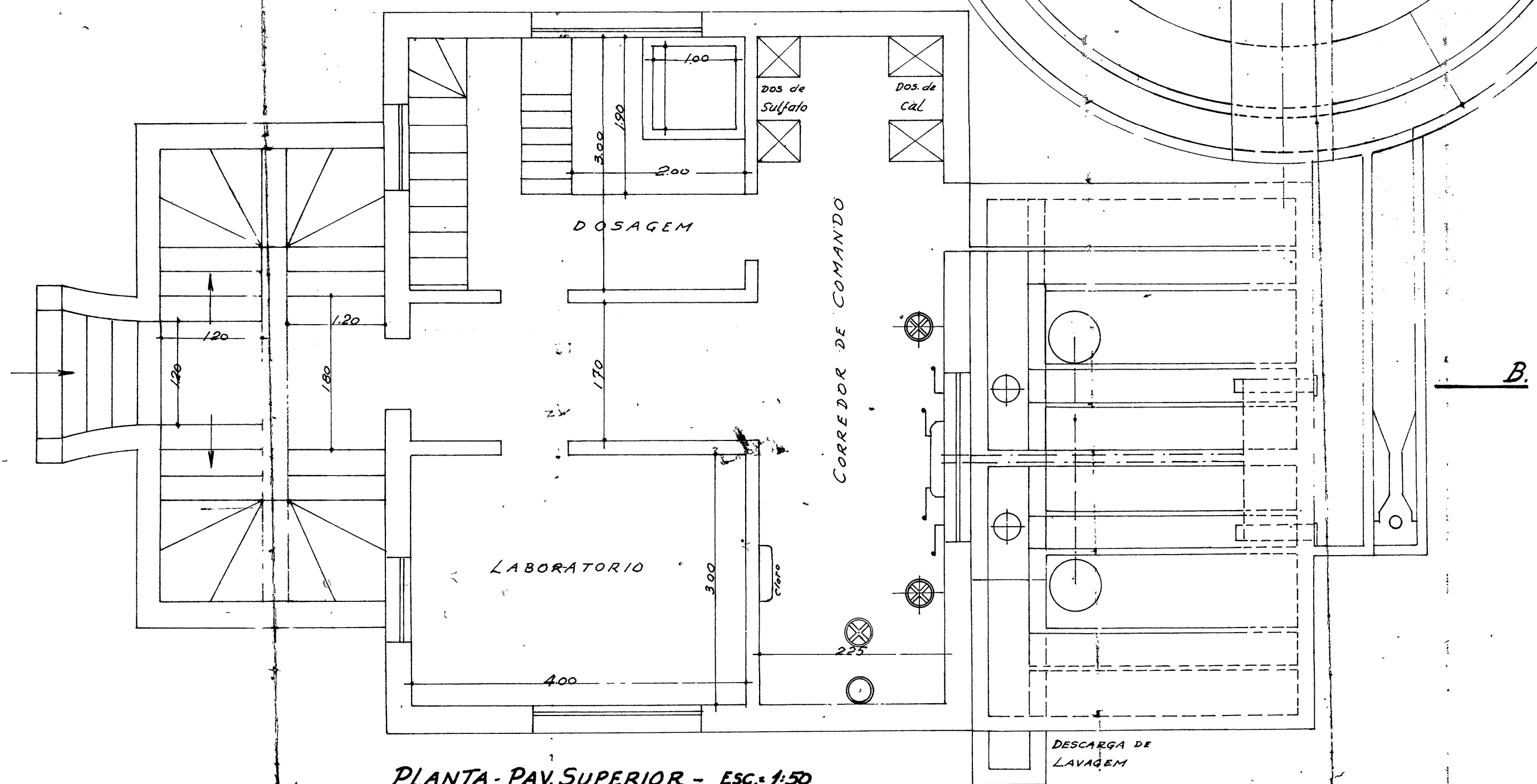
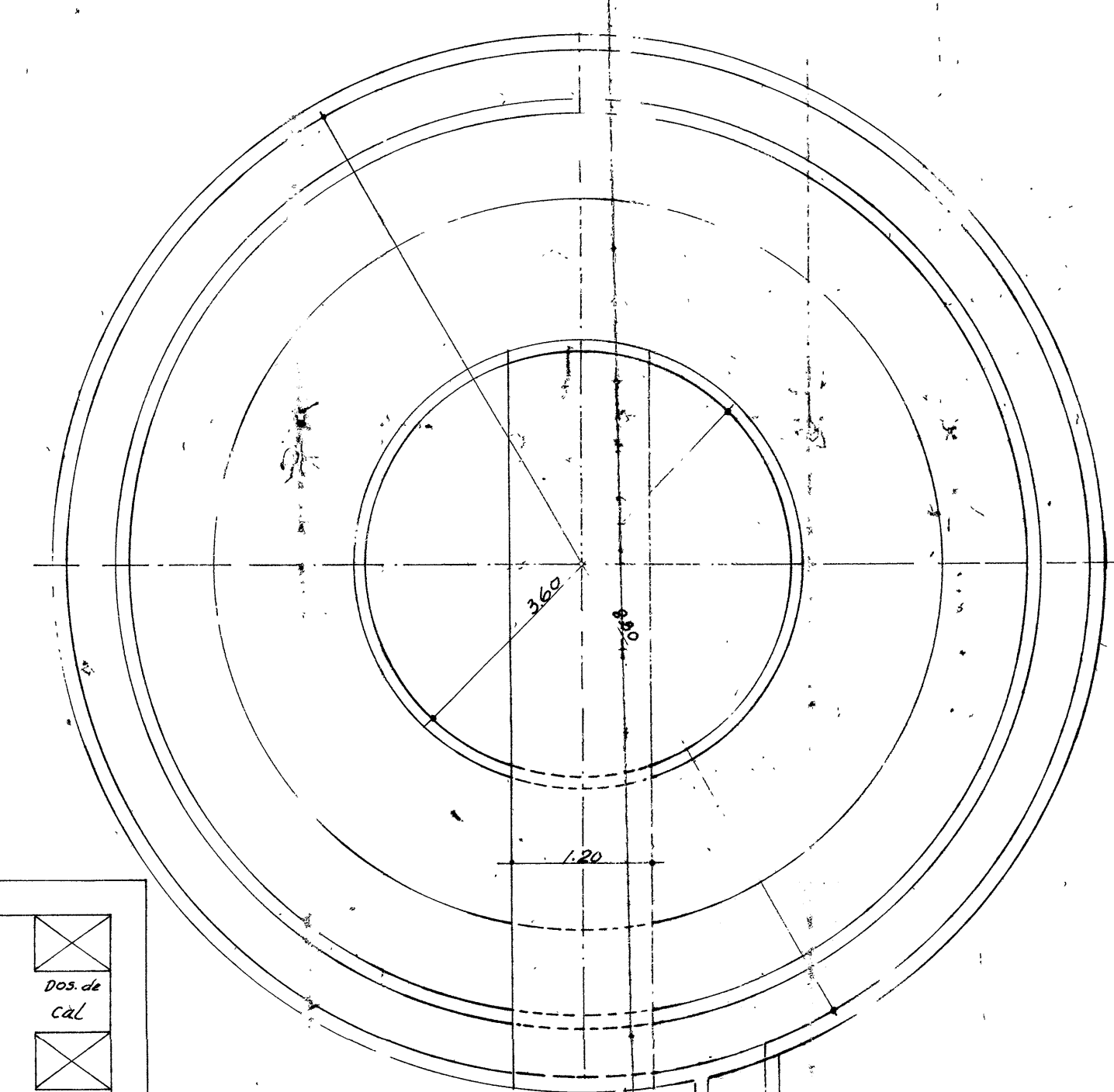

PLANTA - PAV. SUPERIOR - Esc. 1:50

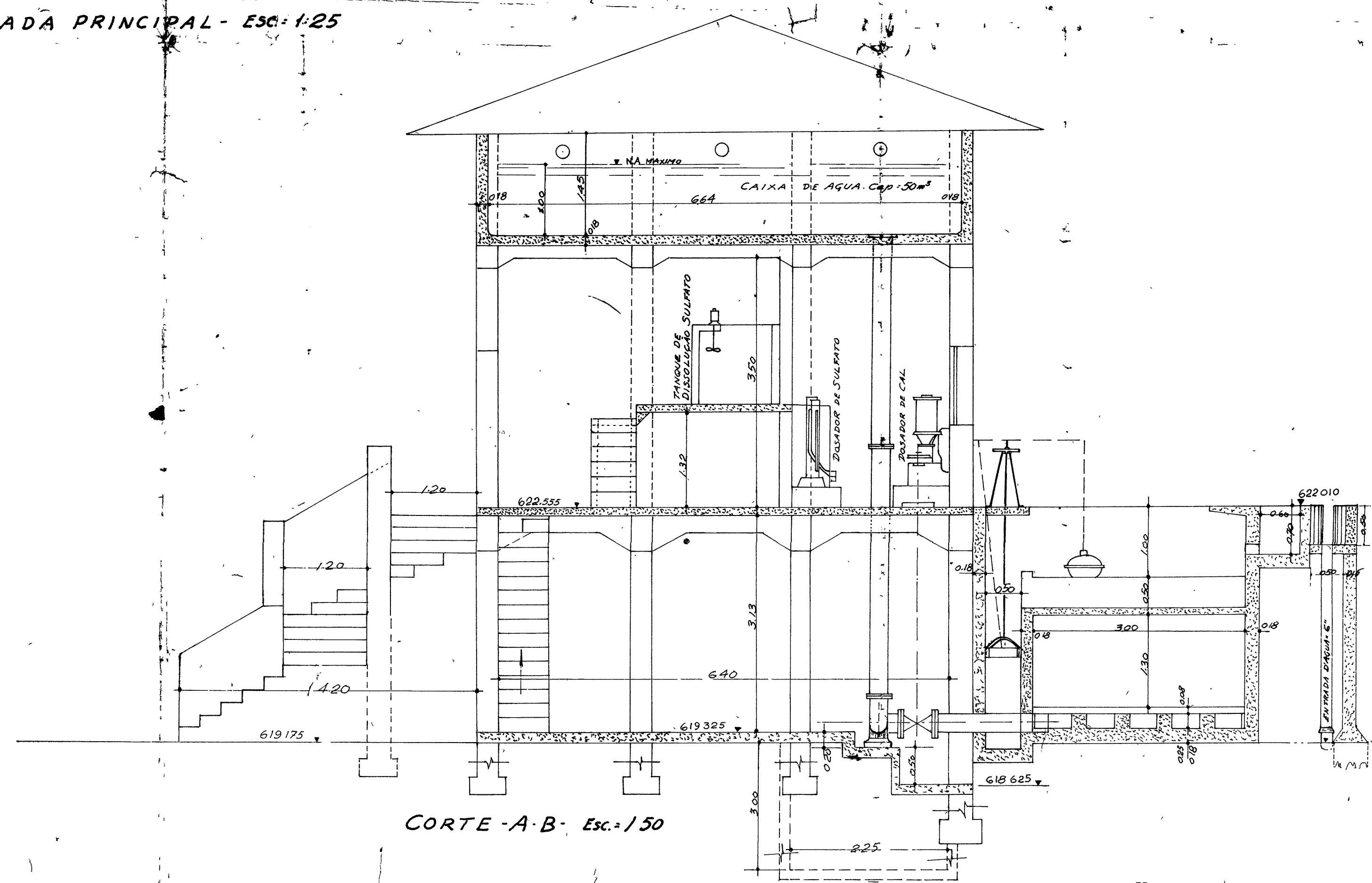

CORTE - A-B - Esc. 1:50

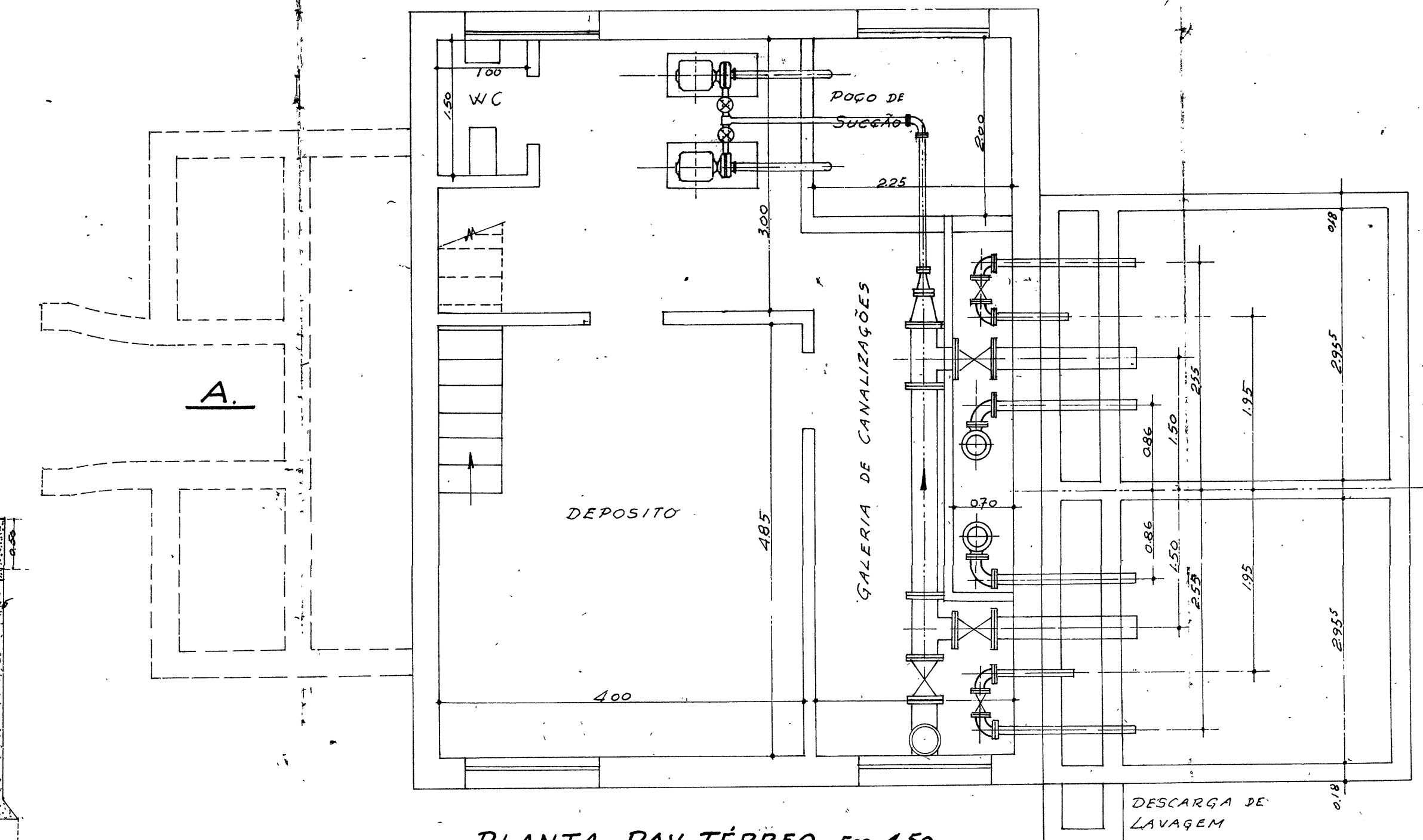

PLANTA - PAV. TERREO - Esc. 1:50

PREFEITURA MUNICIPAL
DE
JAGUARIUNA
PROJETO DAS INSTALAÇÕES
PARA ABASTECIMENTO DE AGUA
A CIDADE -
PLANTA GERAL DA CASA DE QUIMICA
ESCALAS INDICADAS

COMPLAS: 15 - Julho 1962

D.O.S. CARLOS SALTEIRO DE ARAUJO